

T8	VITO	Code	Dimensions	
			A (mm)	
2 x 18W	c/w high frequency ballast	SSFLV218HFL	657	Fig 156
2 x 36W	c/w high frequency ballast	SSFLV236HFL	1267	Fig 156
2 x 58W	c/w high frequency ballast	SSFLV258HFL	1567	Fig 156
2 x 70W	c/w high frequency ballast	SSFLV270HFL	1831	Fig 156

T5	VITO	Code	Dimensions	
			A (mm)	
2 x 28W	c/w high frequency ballast	SSFLV228HFL	1267	Fig 156
2 x 35W	c/w high frequency ballast	SSFLV235HFL	1567	Fig 156
2 x 54W	c/w high frequency ballast	SSFLV254HFL	1267	Fig 156
2 x 80W	c/w high frequency ballast	SSFLV280HFL	1567	Fig 156

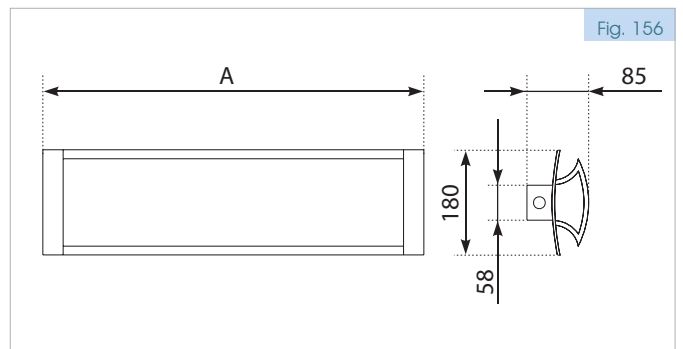

Slimline surface/suspended direct/indirect luminaire with aesthetically pleasing winged reflector and micro perforated opal lined central basket. An array of slotted holes in the back of the reflector introduces an upright component for the illumination of ceilings with suspended versions of the Vito. White powder coated steel body and basket c/w polycarbonate end-caps.

VITO

- For 3HR maintained integral emergency add **EM** to the end of the above product codes for example **SSFLV228EM**
- **Installation** - By suspension, or by mounting direct on to non-flammable surface
- **Dimming** - Dimmable ballast details available on request

- **Lamps (T8)** - Not included
- **Lamps (T5)** - Included
- **IP20** - 240 Volts 50Hz - Nominal supply